

For Lease or Sale

High Image ±37,552 SF Office/R&D Building

2323 Owen Street
Santa Clara, CA

Completely renovated
facility- new roof, glass
and landscaping



Extensive glass line provides
exceptional light

Santa Clara power - 2000 Amps
@ 277/480V

Low expenses ± \$0.22/SF

3.8/1000 parking ratio- 144 spaces

San Tomas Expressway frontage

Lease Rate: \$1.75/NNN with \$30
TI Allowance

Sale Price: \$165/SF (cold shell)

*Building is alarmed- please call
agents or Southbay for code



Contact

Michael J. Webber

T: 408.588.2325

C: 408.888.6363

mwebber@kiddermathews.com

LIC #00870382

Bruce Horton

T: 408.588.2331

bhorton@kiddermathews.com

LIC #00696242

South Bay
DEVELOPMENT COMPANY

For Lease or Sale

High Image ±37,552 SF Office/R&D Building

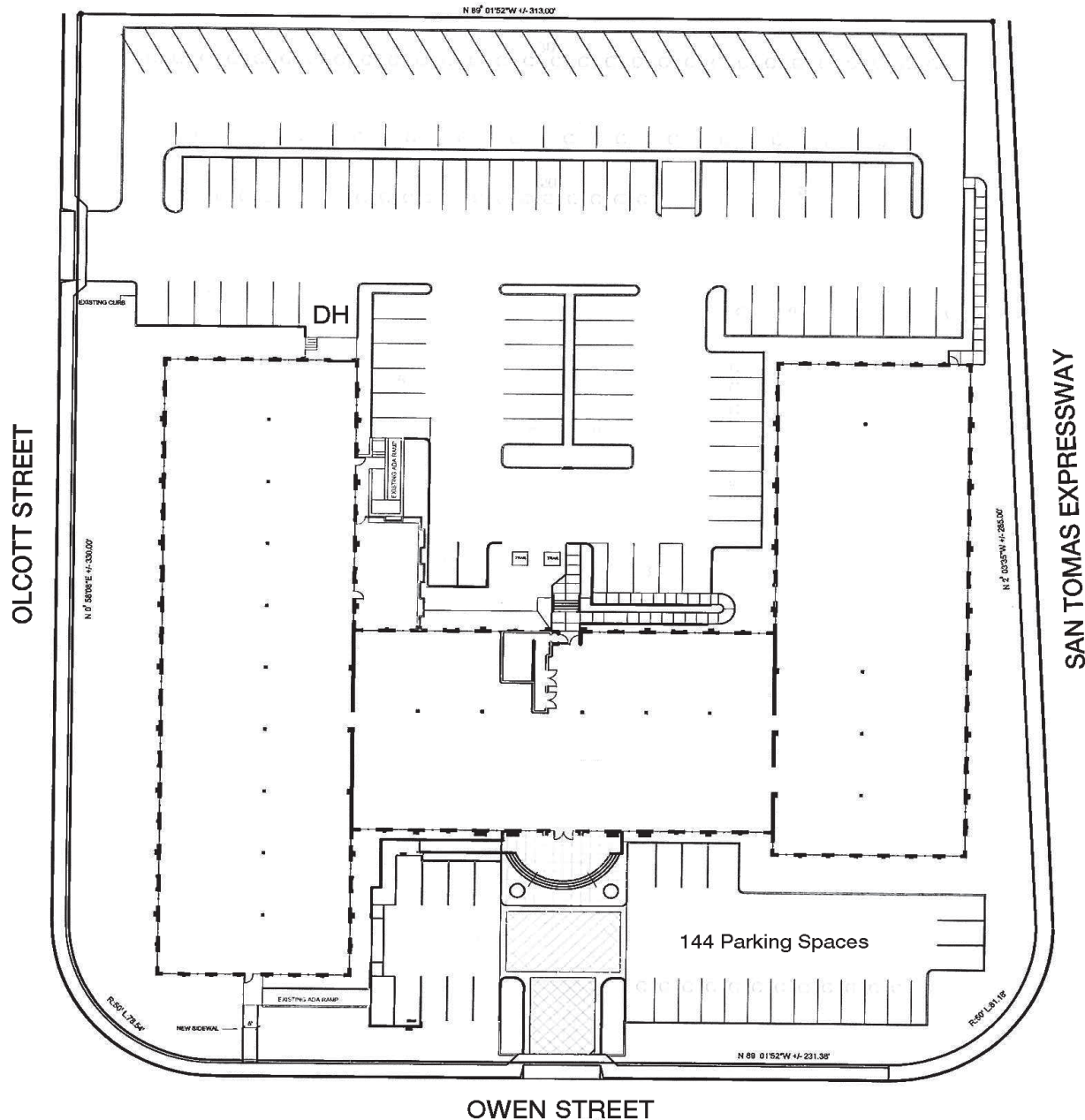

Contact

Michael J. Webber
T: 408.588.2325
C: 408.888.6363
mwebber@kiddermathews.com
LIC #00870382

Bruce Horton
T: 408.588.2331
bhorton@kiddermathews.com
LIC #00696242