

FOR LEASE | R&D/INDUSTRIAL

1506-C Dell Avenue, Campbell, CA

4,840 SQUARE FEET



Building Features

- > 4,840 SF
- > 100% HVAC
- > 400 Amps @ 120/208 Volts
- > 1 Grade Level Door
- > 18' Clear Height
- > Fully Sprinklered
- > 2.4/1,000 Parking
- > Excellent Access to Highways 17 & 85
- > Next to Los Gatos Creek Park, Bicycle & Jogging Paths

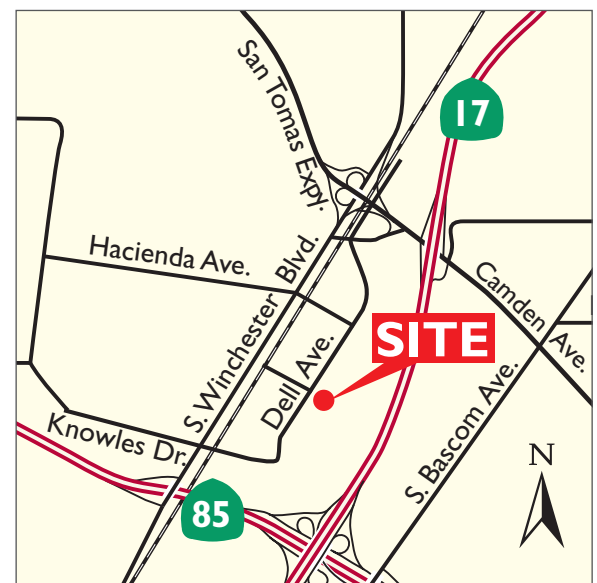

ED HOFER, SIOR
+1 408 282 3819
ed.hofer@colliers.com
CA License No 00923494

BRENT DRESSEN
+1 408 282 3979
brent.dressen@colliers.com
CA License No. 01425986

COLLIERS INTERNATIONAL
Silicon Valley
450 West Santa Clara Street
San Jose, CA 95113
www.colliers.com

1506-C Dell Avenue

4,840 Square Feet

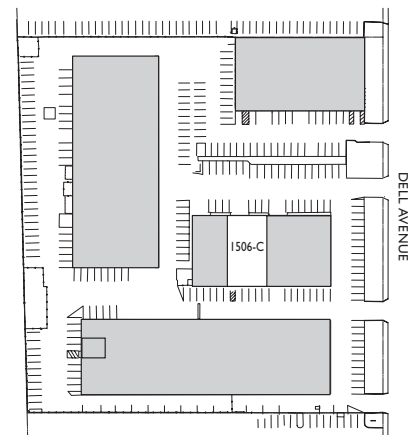
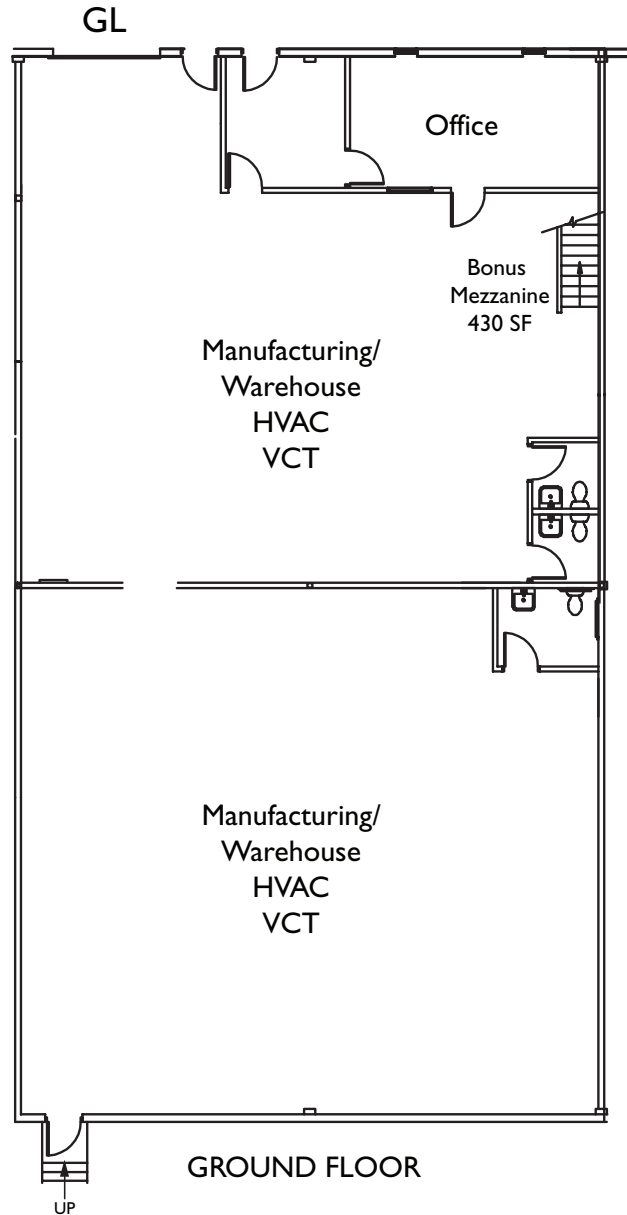

Drawings not exact/not to scale. The information furnished has been obtained from sources we deem reliable and is submitted subject to errors, omissions and changes. Although Colliers International has no reason to doubt its accuracy, we do not guarantee it. All information should be verified by the recipient prior to lease, purchase, exchange, or execution of legal documents. © 2012 Colliers International

ED HOFER, SIOR
+1 408 282 3819
ed.hofer@colliers.com
CA License No 00923494

BRENT DRESSEN
+1 408 282 3979
brent.dressen@colliers.com
CA License No. 01425986

COLLIERS INTERNATIONAL
Silicon Valley
450 West Santa Clara Street
San Jose, CA 95113
www.colliers.com